



Pro Modular Housing **Solutions**



Avo-661

960 Sq.ft.

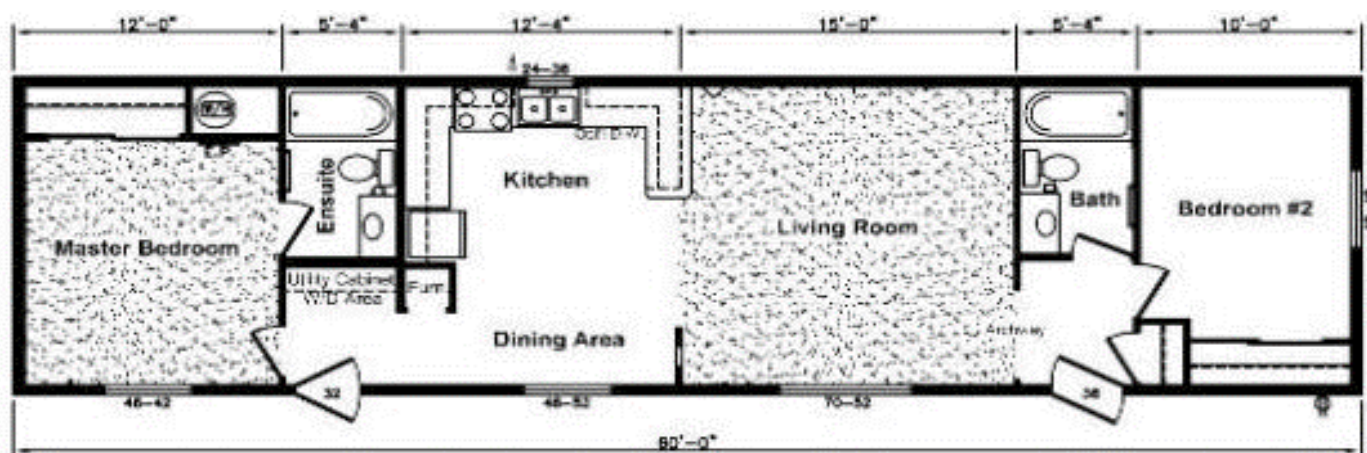

Popular Options:

*Bay Window
Laminate Flooring
Banjo Counter Top
Vinyl Shutters*

*Under Cabinet Lighting
Stainless Steel Appliances
Ceramic Tile Backsplash*



www.promodularsolutions.com

306-216-6261



Pro Modular Housing **Solutions**

Avonlea 16' Wide Standards

Exterior:

30-Year Architectural Fiberglass Shingles
Engineered Roof Trusses
Perimeter Eave & Continuous Ridge Venting
Maintenance Free Full Vinyl Siding
12" Residential Overhang on 3 Sides
White Metal Fascia
8' Walls Ceilings
2x6 Outside Walls at 16" O.C.
3/8 OSB Sheathing on Inside & Outside of
Exterior Walls
2x10 Floor Joists
Weatherproof Outside Receptacle Protected w/GFI
Frost Free Tap c/w Check Valve
White Coach Lights at all Doors & on Front of Home

Interior:

T&G OSB Floor Decking - Glued and Screwed
R-40 Insulation in Ceiling
R-20 Insulation in Walls
R-26 Insulation in Floors
6 Mil Poly Vapour Barrier in Ceilings & Sidewalls
Spraytexed 1/2" SR Gyproc Ceilings
Polyurethane Carpet in Living Room & MBedroom
No Wax Vinyl Flooring
Copper Wiring Throughout
Utility Cabinets Above Washer & Dryer
Wire Closet Shelving
Pewter Hardware Package Throughout
Designer Drapery Package including Blinds
on all Windows
Trim Package #2

Kitchen:

18 Cu Ft Two Door Frost Free Fridge - White
30" Glass Door Electric Range - White
Single Lever Faucet
Double Stainless Steel Kitchen Sink
Two Speed Range hood Vented to exterior
Rolled Drawer Hardware

Bathrooms:

GFI Receptacle in Bathroom
Dehumidistat on Main Bath Fan
One Piece Wall Tub/Shower in Main Bath
Single Lever Faucets
White Bath Fixtures
Shower Rod & Curtain in all Bathrooms
Pewter Towel Bar and Paper Holder
Shut-off Valves on All Fixtures

Doors:

36" Steel Insulated Front Door c/w Peephole
32" Steel Insulated Rear Door c/w Peephole
Aluminum Storm Doors at Front & Rear Entry
Pre-Finished Interior Doors

Windows:

White PVC "Low E" Windows with Screens

Utilities:

Smoke/CO Alarms with Battery Back Up in Hallway
Smoke Alarms in All Bedrooms
40 Gallon Natural GAS Water Heater
Natural GAS High Efficiency Furnace c/w Electronic
Ignition
100 AMP Electric Service Panel
Electric Conduit Through Floor
Light Bulb Package

